

# Multipurpose room - Collegium Helveticum STW A2.1

## Library / Small Studio STW A2.1

### Terms of Use

#### General

---

<b>Size</b>	The total usable area is about 45 m <sup>2</sup> .
<b>Utilization concept</b>	The Library STW A2.1 is approved for a maximum of 20 people. The lockable kitchen is an advantage for events with catering.
<b>Permitted events</b>	Lunches, receptions, small events, break room
<b>Equipment</b>	<p>The Library is equipped with the following infrastructure:</p> <ul style="list-style-type: none"><li>• Acoustic ceiling</li><li>• Exhibition lighting (dimnable)</li><li>• Adjoining kitchen</li><li>• Video-conferencing technology (large screen on wheels with adapter; see page 3: Technical possibilities).</li></ul> <p>The room has direct access to the outdoors and a storage room.</p>

#### Conditions of Use

---



<b>Fire regulations</b>	<p>The regulations of the fire protection ordinance of the Gebäudeversicherung Kanton Zürich (GVZ) apply, as well as the special fire regulations of the GVZ. The instructions of the fire police of the city of Zurich and those of the ETH SGU, Fire and Explosion Protection Department.</p> <p>Special attention should be paid to the following regulations (see plan diagrams):</p> <ul style="list-style-type: none"><li>• The corridor areas STW A10.0002 and A10.0001 must be kept clear at all times (see plan diagrams).</li></ul>
-------------------------	---

## Plan: STW Floor A, Room A2.1 (Library)

### room designations

A5	Art and exhibition space: Gallery
A4	Art and exhibition space: Gallery
A2.1	Library (multipurpose Room)
A2.2	Kitchen
A10.0002	Corridor / aisle – not assignable
A10.0003	Corridor / aisle – not assignable
A10.0004	Corridor / aisle – not assignable

### Legend Library / small Studio STW A2.1

	total usable area	circa 20 m <sup>2</sup>
	Escape route horizontal	
	Escape route vertical	

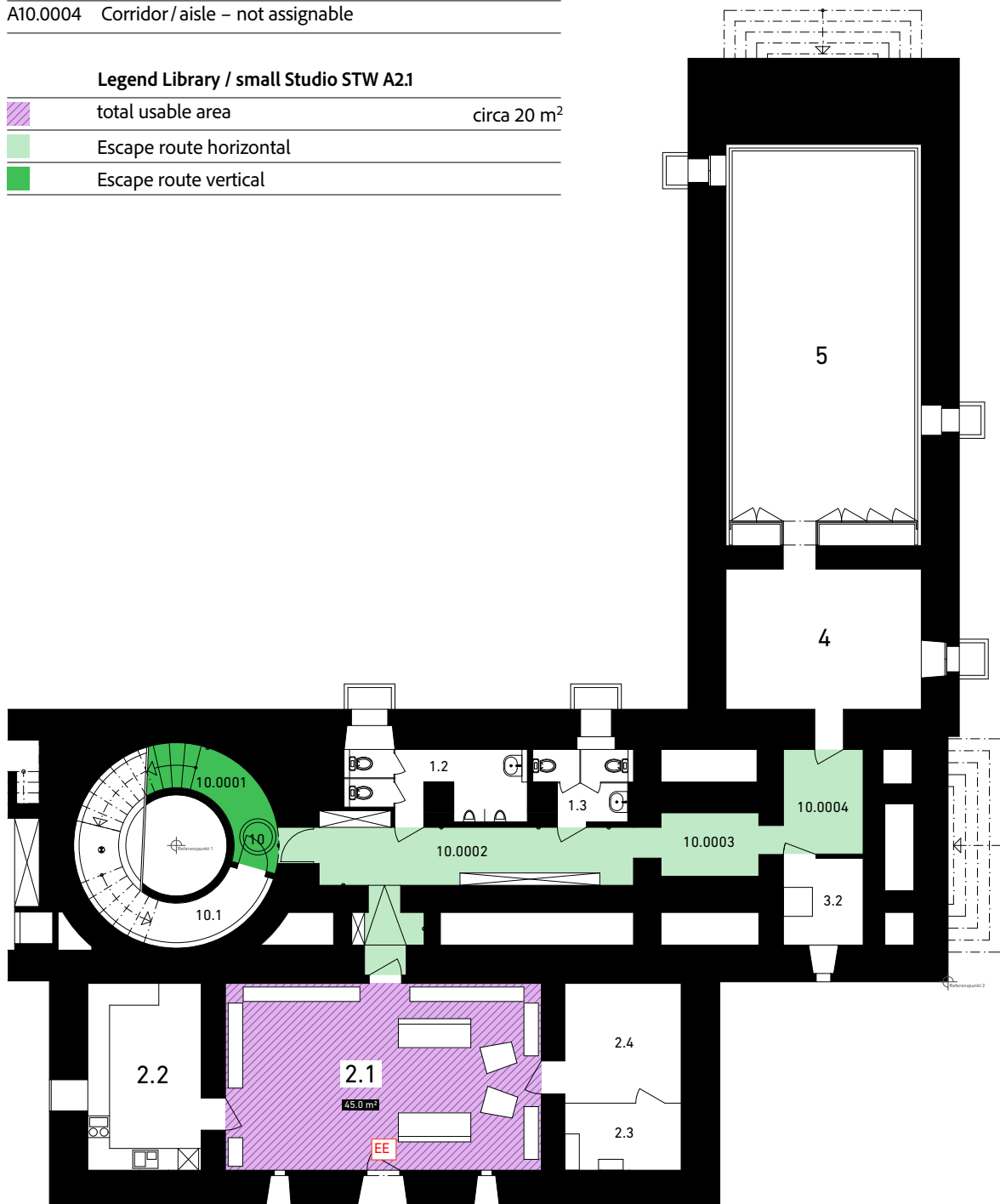

# Technical possibilities – Library

as part of an event taking place at the Collegium Helveticum / STW Observatory

## Video-Conference (Library)

The event takes place on-site in the Library. It does not have to be a conference per se, but might also be a lecture or another form of event. The video-conferencing simply allows for virtual participation.

Virtual participants are using with the presentation laptop (on-site) via Zoom or Teams and can take part in the event virtually. Using the screen share function, the virtual participants are projected onto the screen on-site and are thus visible to the audience present in the studio. The sound of the virtual participants is audible via a soundbar attached to the screen, which combines a speaker and a microphone). The sound of the participants on-site is simultaneously captured by the soundbar and sent to the virtual participants. With a camera fixed on top of the screen the participants on-site are made visible to the virtual participants .

This is a real hybrid-version as all the participants on-site are visible and audible to the virtual participants and vice-versa.

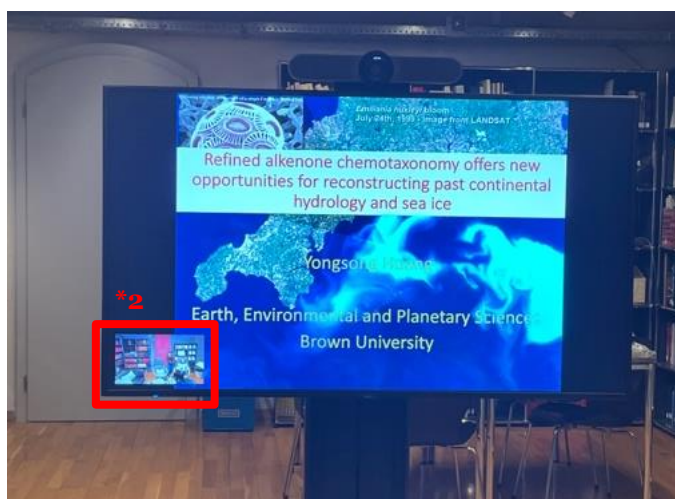

Fig. 1: View of the participants on site with an example of a shared presentation (by a participant on site) and the image of the Zoom meeting on the bottom left. \*2

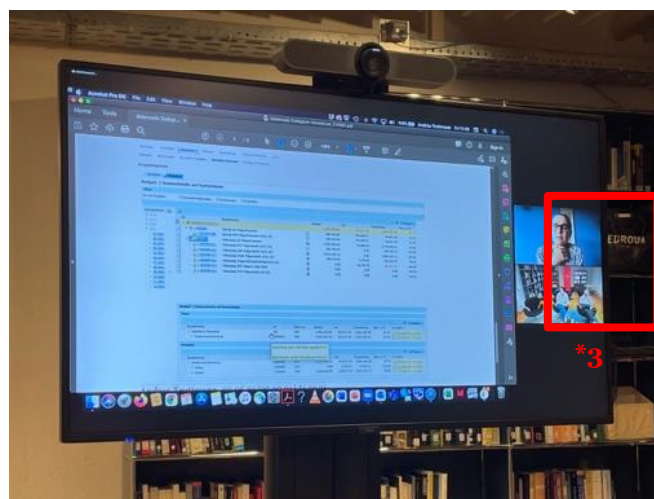

Fig. 2: View of on-site participants with example of a shared presentation (by a virtual participant) and the image of virtual participants and on-site attendees on the right. \*3

## Impressions

Library STW A2.1



Fig. 3: Broadcasting the screen from the host's laptop to the screen (synchronous)

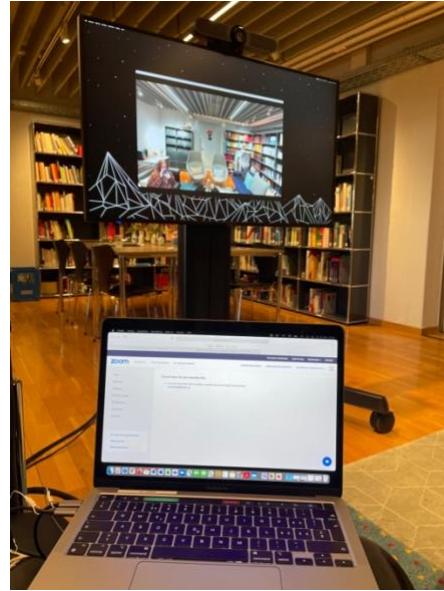

Fig. 4: Broadcasting the screen from the host's laptop to the screen. (not synchronous)



Fig. 5: Library: sofas and armchairs, technical equipment



## Impressions

Library STW A2.1

